

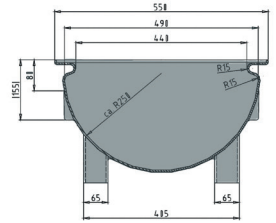

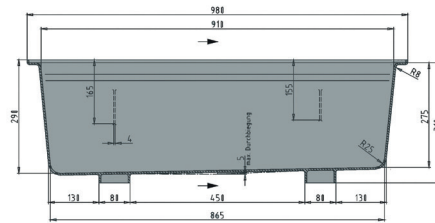



# Trough

100 l



Art. no. 81291111

## Technical data \*1

External Dimensions L x W x H (mm)	980 x 550 x 310		
Internal Dimensions L x W x H (mm)	910 x 440 x 275		
Weight (kg)	6.3		
Volume (l)	100		
Material	HDPE		
Load capacity (kg)	 <b>Holding Capacity</b>	100	 <b>Extra Load</b>
Stacking height (mm)	 <b>When nested</b>	155	 <b>When stacked</b>

## Characteristics

Colour: nature  
 With feet  
 Easy grip all around the top  
 With drain and plug  
 For temperatures ranging from -30 °C to +40 °C, briefly up to +90 °C  
 Resistant to most chemicals and cleaning agents  
 Food-safe. HACCP compliant

## Options

Stand

## Loading quantities (pcs/approx.)

On request.

## Labelling options

Customised printing and numbering available on request depending on quantity. Position upon consultation.



\*1 All technical data include characteristic features, which have been tested under specially defined conditions. Varying data may result from different conditions of usage such as loading method, prevailing temperature and length of storage time. All data and specified information are subject to change without notice. Our service team is pleased to be at your disposal to check the special requirements of your individual application.